

LINHA AGRÍCOLA



Os Cardans NOBRE são divididos em diferentes Séries pois cada Série possui uma aplicação diferente em função de sua capacidade de trabalho, que serão determinadas conforme a potência e o torque que receberão. A tabela abaixo indica a potência (cv) e o torque (N.m) para qual cada Série é indicada.

CARDAN PERFIL QUADRADO

CAPACIDADE DE TRABALHO				
SÉRIES	540 rpm		1000 rpm	
	cv	N.m	cv	N.m
1000	21	270	31	220
1500	27	350	42	297
2000	36	460	55	380
2500	58	747	90	639
5000	78	1000	119	842
6000	120	1560	230	1630

CARDAN PERFIL OVAL

CAPACIDADE DE TRABALHO				
SÉRIES	540 rpm		1000 rpm	
	cv	N.m	cv	N.m
1000	27	355	42	295
2000	38	500	60	415
2500	52	735	80	809

CARDAN PERFIL TRIANGULAR

CAPACIDADE DE TRABALHO				
SÉRIES	540 rpm		1000 rpm	
	cv	N.m	cv	N.m
1000	21	270	31	230
2500	58	747	90	639
5000	78	1000	119	842

CARDAN PERFIL TRIANGULAR - EXPORTAÇÃO

CAPACIDADE DE TRABALHO				
SÉRIES	540 rpm		1000 rpm	
	cv	N.m	cv	N.m
1002	20	270	32	230
2004	35	460	55	380



SÉRIE 100

CÓDIGO	DESCRIÇÃO	FIGURA
TCN 01	T.F. QUADRADO 16,00mm, C/ FURO TRANSV. 5,00mm	01
TCN 02	T.F. SEXTAVADO 16,00mm, C/ FURO TRANSV. 5,00mm	02
TCN 03	T.F. REDONDO 19,53mm, C/ FURO TRANSV. 8,00mm	03
TCN 04	T.F. QUADRADO 19,10mm, C/ FURO TRANSV. 5,00mm	01
TCN 05	T.F. SEXTAVADO 12,70mm, C/ FURO TRANSV. 5,00mm	02
TCN 06	T.F. REDONDO 19,70mm, C/ FURO TRANSV. 13,50 x 8,50mm	03

Figura 01



Figura 02



Figura 03



SÉRIE 1000

CÓDIGO	DESCRIÇÃO	FIGURA
TCN 10	T.E.R. 6 ESTRIAS 1.3/8", F. 14,0mm	01
TCN 10E	T.E.R. 21 ESTRIAS, F. 14,0mm	02
TCN 10T	T. 6 ESTRIAS 1.3/8", S/ FURO	
TCN 11	T.F.Q. 22,22mm, F. TRV. 8,0mm	10
TCN 12	T.F.Q. 28,65mm, F. TRV. 8,0mm	10
TCN 13	T.F.R. 30,00mm, F. TRV. 10,0mm	05
TCN 13E	T.F.R. 30,00mm, F. TRV. 8,0mm	05
TCN 14	T.F.R. 30,00mm, CHAV. 5/16", C/ AP. LAT., S/ INT., F. 13,0mm	04
TCN 14R	T.F.R. 20,00mm, CHAV. 4,0mm, C/ AP. LAT., S/ INT., F. 13,0mm	04
TCN 15	T.F.R. 35,00mm, CHAV. 5/16", C/ AP. LAT., C/ INT., F. 13,0mm	03
TCN 16	T.F.R. 29,20mm, C/ F. TRV. 10,0mm	05
TCN 17	T.F.R. 25,00mm, CHAV. 8,0mm, F. TRV. 8,0mm	06
TCN 18	T. FLANGE 125,00mm, C/ 4 F. 14,0mm, DIST. CENTRO 97,4mm	18
TCN 19	T.F.R. 30,00mm, CHAV. 5/16", F. TRV. 10,0mm	06
TCN 102	T.F.R. 25,00mm, CHAV. 1/4", F. TRV. 10,0mm	06
TCN 103	T.F.R. 19,50mm, CHAV. 1/4", F. TRV. C./ ROSCA 3/8"	11
TCN 104	T.F.R. 30,00mm, CHAV. 3/8", F. C/ ROSCA 3/8" À 180° DA CHAV. E NÃO PASSANTE	07
TCN 105	T. 6 ESTRIAS 1.3/8", F. TRV. 10,0mm	08
TCN 105E	T. 6 ESTRIAS 1.3/8", F. TRV. 8,0mm	08
TCN 106	T.F.R. 30,00mm, CHAV. 5/16", F. TRV. C/ROSCA 3/8" À 90° DA CHAV.	11
TCN 107	T.F.R. 30,00mm, CHAV. 5/16", F. TRV. C/ROSCA 3/8" À 90° DA CHAV. E SOBRE O CANAL DA CHAV.	14
TCN 108	T.F.R. 30,00mm, CHAV. 3/8", F. TRV. 10,0mm À 90° DA CHAV.	06
TCN 109	T.F.R. 30,00mm, CHAV. 5/16", C/AP. LAT., C/INT., F. 13,0mm	03
TCN 110	T.F.R. 35,00mm, CHAV. 3/8", F. TRV. 10,0mm	06
TCN 113	T.F.R. 29,20mm, CHAV. 10,0mm, C/ AP. LAT., S/ INT., F. 13,0mm	04
TCN 115	T.F.R. 30,00mm, CHAV. 5/16", C/ AP. LAT., C/ INT., F. 13,0mm, RAIOS DE INT. 20,5mm	03
TCN 116	T.F.R. 30,00mm, S/ FURO PASSANTE	07
TCN 117	T. FLANGE 125,00mm, PIL. 61,4mm, C/ 4 F. 14,0mm, DIST. CENTRO 100,0mm	18
TCN 120	T. FLANGE 115,00mm, PIL. 9,4mm, C/ 4 F. 10,5mm, DIST. CENTRO 61,0 x 73,0mm	18
TCN 121	T.F.R. 25,40mm, CHAV. 1/4", F. C/ ROSCA 3/8" À 180° DA CHAV.	07
TCN 123	T.F.R. 25,00mm, CHAV. 5/16", F. TRV. 8,0mm	06

SÉRIE 1000

CÓDIGO	DESCRIÇÃO	FIGURA
TCN 124	T.F. SEXTAVADO DE 31,75mm, C/ AP. LAT., C/ INT., F. 13,0mm	15
TCN 124E	T.F. SEXTAVADO DE 31,75mm, C/ ENGATE RÁPIDO 14,0 x 90,0mm	15
TCN 126	T.F.R. 25,00mm, CHAV. 8,0mm, C/ AP. LAT., S/ INT., F. TRV 13,0mm	04
TCN 128	T. FLANGE 125,00mm, ESPESSURA 11,0mm, S/ FURAÇÃO E S/ PILOTO (LISO)	19
TCN 130	T.F.R. 29,00mm, CHAV. 5/16"	12
TCN 131	T. FLANGE 100,00mm, C/ 4 FUIROS 9,0mm, E 4 FUIROS 12,0mm	18
TCN 133	T.F.R. 30,00mm, CHAV. 3/8" C/ AP. LAT., S/ INT., F. 13,0mm	04
TCN 134	T. 6 ESTRIAS 1.3/8", C/ AP. LAT., C/ INT., F. TRV. 13,0mm	13
TCN 135	T.F.Q. 22,50mm, F. TRV. 10,0mm	10
TCN 136	T.F.R. 25,50mm, F. TRV. 10,0mm	05
TCN 137	T.F. SEXTAVADO 28,60mm, C/ AP. LAT., C/ INT., F. 13,0mm	15
TCN 139	TERMINAL GIRO LIVRE - CONJUNTO	17
TCN 140	T.F.R. 30,00mm, CHAV. 3/8", C/ AP. LAT., C/ INT., F. 13,0mm	03
TCN 141	T.F.R. 35,00mm, CHAV. 3/8", C/ AP. LAT., C/ INT., F. TRV. 13,0mm	03
TCN 146	T.F.R. 28,00mm, CHAV. 8,0mm, C/ AP. LAT., S/ INT., F. 13,0mm	04
TCN 148	T.F.R. 35,00mm, CHAV. 10,0mm, C/ AP. LAT., C/ INT., F. 13,0mm	03
TCN 149	T. FLANGE 120,00mm, PIL. 71,4mm, C/ 4 F. 14,0mm, DIST. CENTRO 97,4mm	18
TCN 151	T.F.R. 25,40mm, CHAV. 1/4", C/ AP. LAT., S/ INT., F. TRV. 13,0mm	04
TCN 162	T. FLANGE 125,00mm, C/ 4 F. 14,0mm, DIST. CENTRO 100,0mm	18
TCN 170	T.F.R. 30,00mm, F. TRV. 10,0mm	05
TCN 190	T.F.R. 19,05mm	09
TCN B11	BUCHA ADAPTADORA P/ PROTEÇÃO - TBN 08	10
TCN B12	BUCHA ADAPTADORA P/ PROTEÇÃO - TBN 07	10
TCN H1	TERMINAL H SÉRIE 1000	20

Figura 01



Figura 02



Figura 03

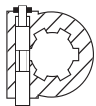

Figura 04

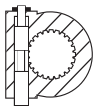

Figura 05



Figura 06



Figura 07

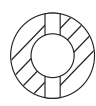

Figura 08

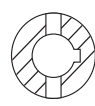

Figura 09

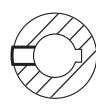

Figura 10

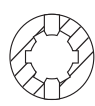

Figura 11

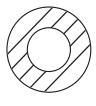

Figura 12

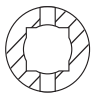

Figura 13

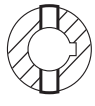

Figura 14

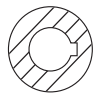

Figura 15



Figura 16

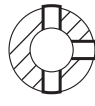

Figura 17



Figura 18



Figura 19



Figura 20





SÉRIE 1500

CÓDIGO	DESCRIÇÃO	FIGURA
TCN 1510	T.E.R. 6 ESTRIAS 1.3/8", F. 14,0mm	01
TCN 1510E	T.E.R. 21 ESTRIAS, F. 14,0mm	02
TCN 1511	T.F.Q. 22,22mm, F. TRV. 8,0mm	04
TCN 1512	T.F.Q. 28,65mm, F. TRV. 8,0mm	04
TCN 1513	T.F.R. 30,00mm, F. TRV. 10,0mm	05
TCN 1514	T.F.R. 35,00mm, F. TRV. 13,0mm PARALELO A ORELHA	05
TCN 1516	T.F.R. 31,75mm, CHAV. 5/16", F. C/ ROSCA 3/8"	07
TCN 1517	T.F.R. 30,00mm, CHAV. 5/16", F. TRV. 10,0mm	06
TCN 1518	T.F.R. 20,70mm, CHAV. 1/4", F. C/ ROSCA 3/8"	07
TCN 1519	T.F.R. 25,40mm, CHAV. 1/4", F. C/ ROSCA 3/8"	07
TCN 1520	T.F.R. 30,00mm, CHAV. 5/16", F. C/ ROSCA 3/8"	07
TCN 1521	T.F.R. 30,00mm, CHAV. 5/16", C/ AP. LAT. S/ INT., F/ TRV. 13,0mm	03
TCN 1524	T.F.R. 25,40mm, CHAV. 1/4", F. C/ ROSCA M10.	07
TCN 1526	T.F.R. 35,00mm, F. TRV. 13,0mm	05
TCN 1528	T.F.R. 35,00mm, CHAV. 3/8", F. TRV. 12,0mm	06
TCN 1534	T.F.R. 25,40mm, CHAV. 1/4", F. C/ ROSCA 3/8", PASSANTE SOBRE O CANAL DA CHAV.	08

Figura 01



Figura 02



Figura 03

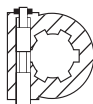

Figura 04

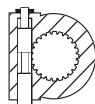

Figura 05

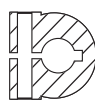

Figura 06

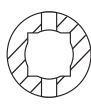

Figura 07

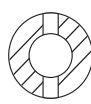

Figura 08

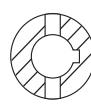

SÉRIE 2000

CÓDIGO	DESCRIÇÃO	FIGURA
TCN 20	T.E.R. 6 ESTRIAS 1.3/8", F. 14,0mm	01
TCN 20E	T.E.R. 21 ESTRIAS, F. 14,0mm	02
TCN 21	T.F.Q. 37,00mm, F. TRV. 8,0mm	03
TCN 22	T.F.Q. 30,00mm, F. TRV. 8,0mm	03
TCN 23	T.F.R. 35,00mm, CHAV. 3/8", F. TRV. 12,0mm	04
TCN 24	T.F.R. 30,00mm, CHAV. 3/8", F. TRV. 10,0mm	04
TCN 25	T.F.R. 35,00mm, CHAV. 3/8", C/ AP. LAT., C/ INT., F. TRV. 13,0mm	05
TCN 26	T. FLANGE 125,00mm, C/ 4 F. 14,0mm, DIST. CENTRO 97,4mm	13
TCN 26E	T. FLANGE 115,00mm, C/ 4 F. 10,5mm, DIST. CENTRO 94,3mm	13
TCN 27	T. FLANGE 120,00mm, C/ PIL. 71,4 x 10,0mm, C/ 4 F. 14,0mm, DIST. CENTRO 97,4mm	14
TCN 32	T.F.R. 35,00mm, CHAV. 10,0mm, C/ AP. LAT., S / INT., F. TRV. 13,0mm	06
TCN 33	T. 6 ESTRIAS 1.3/8", C/ AP. LAT., C/ INT., F. TRV. 13,0mm	09
TCN 38	T.F.R. 38,00mm, CHAV. 3/8", F. C/ ROSCA 3/8" À 180° DA CHAV. E NÃO PASSANTE	08
TCN 39	T.F.R. 35,00mm, CHAV. 3/8", F. TRV. 10,0mm	04
TCN 40	T.F.R. 35,00mm, CHAV. 10,0mm, F. TRV. 12,0mm	04
TCN 41	T.F.R. 31,75mm, F. TRV. 3/8", F. C/ ROSCA 1/4" À 90° DO F. TRV.	19
TCN 42	T. 6 ESTRIAS 1.3/8", F. TRV. 8,0mm	17
TCN 43	T.F.R. 30,00mm, CHAV. 3/8", F. TRV. 12,0mm	04
TCN 44	T.F. SEXTAVADO 28,60mm, C/ F. TRV. 8,0mm	22
TCN 47	T.F.R. 31,75mm, CHAV. 1/4", F. C/ ROSCA 3/8" À 180° DA CHAV. E NÃO PASSANTE	08
TCN 48	T.F.R. 25,00mm, CHAV. 1/4", F. TRV. 10,0mm	04
TCN 49	T.F.R. 30,00mm, CHAV. 5/16", C/ AP. LAT., S/ INT., F. TRV. 13,0mm	06
TCN 200	T.F.R. 40,00mm, CHAV. 3/8", F. TRV. 10,0mm	04
TCN 200E	T.F.R. 42,00mm, CHAV. 3/8", F. TRV. 10,0mm	04
TCN 202	T.F.R. 30,00mm, F. TRV. 10,0mm	07
TCN 203	T.F.R. 35,00mm, CHAV. 5/16", C/ AP. LAT., S/ INT., F. TRV. 13,0mm	06
TCN 204	T.F.R. 35,00mm, CHAV. 3/8", F. C/ ROSCA 1/2" À 180° DA CHAV., F. TRV. 12,0mm	11
TCN 206	T.F.R. 30,00mm, CHAV. 8,0mm, C/ AP. LAT., C/ INT., RAIOS 19,0mm, F. TRV. 13,0mm	05
TCN 207	T.F.R. 30,00mm, CHAV. 5/16", C/ AP. LAT., C / INT., F. TRV. 13,0mm	05
TCN 208	T.F.R. 30,00mm, CHAV. 5/16", F. TRV. 10,0mm	04
TCN 209	T. 21 ESTRIAS C/ AP. LAT., C/ INT., F. TRV. 13,0mm	18
TCN 210	T. FLANGE 125,00mm, C/ PIL. 61,5 x 2,0mm, C/ 4 F. 14,0mm, DIST. CENTRO 100,0mm	14
TCN 211	T.F.R. 35,00mm, F. C/ ROSCA M10, F. TRV. 12,0mm	19
TCN 213	T.F.R. 24,00mm, CHAV. 1/4", F. TRV. 10,0mm	04
TCN 213E	T.F.R. 25,40mm, CHAV. 1/4", F. TRV. 10,0mm	04
TCN 214	T.F.R. 30,00mm, CHAV. 3/8", C/ AP. LAT., C / INT., F. TRV. 13,0mm	05
TCN 215	T.F.R. 35,00mm, CHAV. 3/8", C/ AP. LAT., S/ INT., F. TRV. 13,0mm	06
TCN 218	T.F.R. 28,00mm, CHAV. 8,0mm, F. TRV. C/ ROSCA M8 À 180° DA CHAV.	12
TCN 219	T.F.R. 35,00mm, F. TRV. 10,0mm	07
TCN 220	T.F.R. 35,00mm, F. TRV. 12,0mm	07
TCN 221	T.F.R. 35,00mm, CHAV. 10,0mm, C/ AP. LAT., C/ INT., F. TRV. 13,0mm	05
TCN 223	T.F.R. 40,00mm, F. TRV. 10,0mm	07
TCN 225	T.F.R. 35,00mm, CHAV. 5/16", C/ AP. LAT., C / INT., F. TRV. 13,0mm	05
TCN 226	T.F.R. 29,20mm, CHAV. 5/16"	15
TCN 227	T.F. SEXTAVADO 31,75mm, F. TRV. 8,0mm	22
TCN 230	T. FLANGE 125,00mm, C/ 4 F. 14,0mm, DIST. CENTRO 100,0mm	13
TCN 231	T.F.R. 30,00mm, CHAV. 3/8", C/ AP. LAT., S/ INT., F. TRV. 13,0mm	06

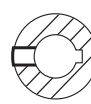

SÉRIE 2000

CÓDIGO	DESCRIÇÃO	FIGURA
TCN 232	T. FLANGE 125,00mm, C/ 4 F. 16,0mm, DIST. CENTRO 97,4mm	13
TCN 233	TERMINAL PINO FUSÍVEL (MONTADO)	16
TCN 234	T. FLANGE 125,00mm, C/ PIL. DE 71,4 x 10,0mm, C/ 4 F. 14,0mm, DIST. CENTRO 100,0mm	14
TCN 237	T.F. SEXTAVADO 28,60mm, C/ AP. LAT., S/ INT., F. TRV. 13,0mm	23
TCN 238	TERMINAL GIRO LIVRE - CONJUNTO	25
TCN 239	T.F.R. 35,00mm, CHAV. 10,0mm, F. TRV. 12,0mm	04
TCN 240	T.F.R. 30,00mm, C/ AP. LAT., C/ INT., F. 13,0mm E F. TRV. 12,0mm	10
TCN 241	T. FLANGE 125,00mm, C/ F. INT. 35,00mm, CHAV. 10,0mm, C/ 4 F. 14,0mm, DIST. CENTRO 100,0mm	13
TCN 247	T.F. SEXTAVADO 28,60mm, C/ ENGATE RÁPIDO 14 x 9,0mm	21
TCN 248	T.F. SEXTAVADO 31,75mm, C/ AP. LAT., C/ INT., F. TRV. 13,0mm	20
TCN 249	T.F. SEXTAVADO 31,75mm, C/ ENGATE RÁPIDO 14 x 9,0mm	21
TCN 300	T. FLANGEADO	23
TCN 310	T.F.R. 40,00mm, CHAV. 3/8", F. C/ ROSCA 3/8", À 180° DA CHAV. E NÃO PASSANTE	08
TCN 424	T.F.R. 25,00mm, CHAV. 8,0mm, F. TRV. 10,0mm	04
TCN 425	T.F.R. 25,00mm, CHAV. 8,0mm, F. C/ ROSCA M 10, À 180° DA CHAV. E NÃO PASSANTE	08
TCN 430	T.F.R. 25,40mm, CHAV. 1/4", F. TRV. 8,0mm	04
TCN B21	BUCHA ADAPTADORA P/ PROTEÇÃO - TBN 28	03
TCN B22	BUCHA ADAPTADORA P/ PROTEÇÃO - TBN 29	03
TCN H2	TERMINAL H SÉRIE 2000	24

Figura 01



Figura 02



Figura 03

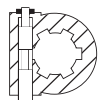

Figura 04

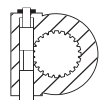

Figura 05

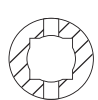

Figura 06

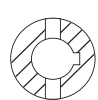

Figura 07



Figura 08



Figura 09

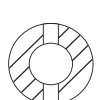

Figura 10

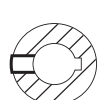

Figura 11

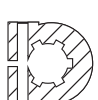

Figura 12



Figura 13

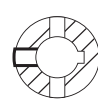

Figura 14

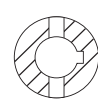

Figura 15

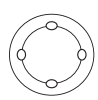

Figura 16

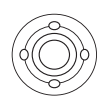

Figura 17

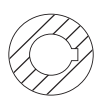

Figura 18

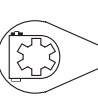

Figura 19

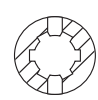

Figura 20

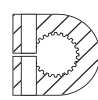

Figura 21

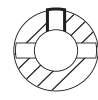

Figura 22



Figura 23

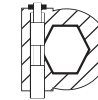

Figura 24

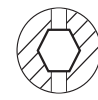

Figura 25

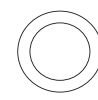

SÉRIE 2500

CÓDIGO	DESCRIÇÃO	FIGURA
TCN 250	T.E.R. 6 ESTRIAS 1.3/8", F. 14,0mm	01
TCN 250E	T.E.R. 21 ESTRIAS, F. 14,0mm	02
TCN 251	T.F.Q. 39,85mm, F. TRV. 10,0mm	03
TCN 252	T.F.Q. 30,10mm, F. TRV. 10,0mm	03
TCN 253	T. FLANGE 120,00mm, PIL. 75,0 x 2,5mm, C/ 8 F. 10,0mm, DIST. CENTRO 101,5mm, C/ RESSALTO	13
TCN 254	T.F.R. 30,00mm, CHAV. 5/16", C/ AP. LAT., S / INT., F. TRV. 13,0mm	05
TCN 255	T.F.R. 35,00mm, CHAV. 10,0mm, C/ AP. LAT., S / INT., F. TRV. 13,0mm	05
TCN 256	T. FLANGE 125,00mm, C/ 4 F. 14,0mm, DIST. CENTRO 97,4mm	14
TCN 257	T.F.R. 35,00mm, CHAV. 3/8", F. TRV. 10,0mm	09
TCN 259	T.F. SEXTAVADO 28,60mm, C/ ENGATE RÁPIDO	12
TCN 260	T.F.R. 30,00mm, CHAV. 3/8", C/ AP. LAT., S/ INT., F. TRV. 13,0mm	05
TCN 261	T. 21 ESTRIAS, C/ AP. LAT., C/ INT., F. TRV. 13,0mm	04
TCN 265	T.F.R. 35,00mm, CHAV. 10,0mm, F. TRV. 12,0mm	09
TCN 267	T.F. SEXTAVADO 28,60mm, C/ AP. LAT., C/ INT., F. 13,0mm	10
TCN 268	T.F.R. 35,00mm, CHAV. 10,0mm, C/ AP. LAT., C/ INT., F. TRV. 13,0mm, PROF. CHAV. 8,0mm	08
TCN 269	T.F.R. 35,00mm, CHAV. 5/16", C/ AP. LAT., C/ INT., F. TRV. 13,0mm	08
TCN 270	T. FLANGE 120,00mm, PIL. 71,40mm, C/ 4 F. 14,0mm, DIST. CENTRO 97,4mm	14
TCN 272	T.F. SEXTAVADO 31,75mm, C/ ENGATE RÁPIDO 14,0X9,0mm	12
TCN 273	T.F.R. 30,00mm, CHAV. 3/8", C/ AP. LAT., C/ INT. F. TRV. 13,0mm	08
TCN 275	T.F.Q. 31,75mm, F. TRV. 10,0mm	03
TCN 276	T.F.R. 35,00mm, CHAV. 3/8", C/ AP. LAT., S/ INT., F. TRV. 13,0mm	05
TCN 277	T.F. SEXTAVADO 28,60mm, C/ AP. LAT., S/ INT., F. 13,0mm	10
TCN 278	T.F. SEXTAVADO 31,75mm, C/ AP. LAT., C/ INT., F. TRV. 13,0mm	10
TCN 282	T.F.R. 30,00mm, CHAV. 5/16", F. TRV. 10,0mm	09
TCN 283	T. FLANGE 120,00mm, C/ 8 F. 10,0mm, DIST. CENTRO 101,5mm	13
TCN 285	T. FLANGE 120,00mm, C/ 4 F. 14,0mm, DIST. CENTRO 97,4mm	14
TCN 286	T.F.R. 38,00mm, CHAV. 3/8", C/ AP. LAT., C/ INT., F. TRV. 13,0mm	08
TCN 287	T. FLANGE 125,00mm, PIL. C/ REBAIXO 70,0mm, C/ 4 F. 14,0mm, DIST. CENTRO 97,4mm	14
TCN 288	T. FLANGE 125,00mm, PIL. 70,0mm, C/ 4 F. 14,0mm, DIST. CENTRO 97,4mm	14
TCN 290	T.F.R. 35,00mm, CHAV. 3/8", C/ AP. LAT., C/ INT., F. TRV. 13,0mm	08
TCN 291	T.F.R. 35,00mm, F. C/ ROSCA M10, F. TRV. 12,0mm PARALELO À ORELHA	07
TCN 292	T. 6 ESTRIAS 1.3/8", C/ AP. LAT., C/ INT., F. TRV. 13,0mm	06
TCN 294	T.F.R. 30,00mm, CHAV. 5/16", C/ AP. LAT., C/ INT., F. TRV. 13,0mm	08
TCN 295	T.F.R. 35,00mm, CHAV. 10,0mm, C/ AP. LAT., C/ INT., F. TRV. 13,0mm	08
TCN 296	T. FLANGE 125,00mm, C/ 4 F. 14,0mm, DIST. CENTRO 100,0mm	14
TCN 297	TERMINAL PINO FUSÍVEL (MONTADO)	11
TCN 298	T. 6 ESTRIAS 1.3/8", F. TRV. 8,0mm	15
TCN 299	T.F.R. 30,00mm, CHAV. 3/8", F. TRV. 10,0mm	09
TCN 710	T. FLANGE 111,00mm, C/ 4 F. 10,5mm, DIST. CENTRO 91,0mm	14

Figura 01



Figura 02



Figura 03



Figura 04



Figura 05



Figura 06



Figura 07



Figura 08



Figura 09



Figura 10



Figura 11



Figura 12



Figura 13



Figura 14



Figura 15





SÉRIE 5000

CÓDIGO	DESCRIÇÃO	FIGURA
TCN 50	T.E.R. 6 ESTRIAS 1.3/8", F. 14,0mm	01
TCN 50E	T.E.R. 21 ESTRIAS, F. 14,0mm	09
TCN 51	T.F.Q. 45,30mm, F. TRV. 10,0mm	08
TCN 52	T.F.Q. 37,00mm, F. TRV. 10,0mm	08
TCN 56	T. 6 ESTRIAS, 1.3/8", C/ AP. LAT., C/ INT., F. 13,0mm	05
TCN 57	T.F.R. 35,00mm, CHAV. 3/8", C/ AP. LAT., C/ INT., F. TRV. 13,0mm	03
TCN 61	T.F.R. 35,00mm, CHAV. 10,0mm C/ PROF. 3,5mm, C/ AP. LAT., C/ INT., F. TRV. 13,0mm	03
TCN 61E	T.F.R. 35,00mm, CHAV. 10,0mm C/ PROF. 5,0mm, C/ AP. LAT., C/ INT., F. TRV. 13,0mm	03
TCN 63	T.F.R. 45,00mm, CHAV. 3/8", F. TRV. 9,5mm	02
TCN 65	T.F.R. 35,00mm, CHAV. 3/8", F. TRV. 10,0mm	02
TCN 66	T. 21 ESTRIAS, C/ AP. LAT., C/ INT., F. TRV. 13,0mm	06
TCN 67	T.F.R. 40,00mm, CHAV. 1/2", F. TRV. 10,0mm	02
TCN 68	T.F.R. 45,00mm, CHAV. 3/8", C/ AP. LAT., C/ INT., F. TRV. 13,0mm	03
TCN 69	T.F.R. 40,00mm, F. TRV. 10,0mm	07
TCN 70	TERMINAL PINO FUSIVEL (MONTADO)	10
TCN 71	T.F.R. 30,00mm, CHAV. 10,0mm, C/ AP. LAT., S/ INT., F. TRV. 13,0mm	04
TCN 73	T.F.R. 40,00mm, CHAV. 1/2", F. TRV. 1/2" C/ ROSCA	11
TCN 80	T.F.R. 35,00mm, CHAV. 10,0mm, C/ AP. LAT., C/ INT., F. TRV. 13,0mm	03
TCN 81	T.F.R. 30,00mm, CHAV. 3/8", C/ AP. LAT., S/ INT., F. TRV. 13,0mm	04
TCN 82	T.F.R. 35,00mm, CHAV. 5/16", C/ AP. LAT., C/ INT., F. TRV. 13,0mm	03
TCN 85	T.F.R. 40,00mm, CHAV. 5/16", C/ AP. LAT., C/ INT., F. 13,0mm	03
TCN 86	T. 6 ESTRIAS 1.3/4", C/ AP. LAT., C/ INT., F. 16,0mm	05
TCN 87	T.F.R. 30,00mm, CHAV. 5/16", F. TRV. 10,0mm	02
TCN 88	T. 6 ESTRIAS 1.3/4", C/ ENGATE RÁPIDO, F. 14,0mm	01
TCN 90	T.F.R. 45,00mm, CHAV. 3/8", F. C/ ROSCA 1/2" A 90° DA CHAV. E SOBRE A CHAV.	12
TCN 92	T.F.R. 45,00mm, CHAV. 10,0mm, F. TRV. 1/2" C/ ROSCA	11
TCN 93	T.F.R. 40,00mm, F. TRV. 13,0mm	07
TCN 95	T.F.R. 35,00mm, CHAV. 10,0mm, C/ AP. LAT., S/ INT., F. TRV. 13,0mm	04
TCN 96	T.F.R. 40,00mm, CHAV. 10,0mm, C/ AP. LAT., C/ INT., F. TRV. 13,0mm	03
TCN 98	T.F.R. 35,00mm, F. TRV. 13,0mm	07
TCN B51	BUCHA ADAPTADORA P/ PROTEÇÃO - TBN 58	08
TCN B52	BUCHA ADAPTADORA P/ PROTEÇÃO - TBN 59	08

Figura 01



Figura 02



Figura 03

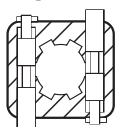

Figura 04

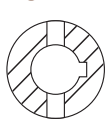

Figura 05



Figura 06



Figura 07

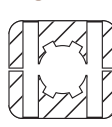

Figura 08

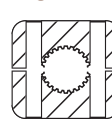

Figura 09

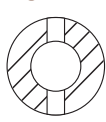

Figura 10

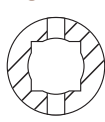

Figura 11

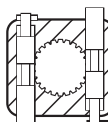

Figura 12

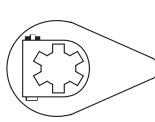

SÉRIE 6000

CÓDIGO	DESCRIÇÃO	FIGURA
TCN 600	T.E.R. 6 ESTRIAS 1.3/8", F. 14,0mm	01
TCN 600E	T.E.R. 21 ESTRIAS, F. 14,0mm	02
TCN 601	T.F.Q. 50,20mm, F. TRV. 10,0mm	06
TCN 602	T.F.Q. 37,00mm, F. TRV. 10,0mm	06
TCN 601E	T.F.R. 48,10mm, C/ ENCAIXE PROTEÇÃO	09
TCN 602E	T.F.R. 43,60mm, C/ ENCAIXE PROTEÇÃO	09
TCN 603	T.R.F. 35,00mm, CHAV. 3/8", C/ AP. LAT., C/ INT., F. 13,0mm	03
TCN 604	T.E.R. 6 ESTRIAS 1.3/4", F. 14,0mm	01
TCN 606	T.F.R. 45,00mm, CHAV. 3/8", F. TRV. 3/8"	04
TCN 607	T. 6 ESTRIAS 1.3/8", C/ AP. LAT., C/ INT., F. 13,0mm	05
TCN 608	T.F.R. 40,00mm, CHAV. 3/8"	08
TCN 611	T.F.R. 38,00mm, CHAV. 3/8", C/ AP. LAT., C/ INT., F. TRV.13,0mm	03
TCN 612	T.F.R. 45,00mm, CHAV. 3/8", C/ AP. LAT., C/ INT., F. TRV.13,0mm	03
TCN 613	T.F.R. 35,00mm, CHAV. 10,0mm, C/ AP. LAT., C/ INT., F. TRV. 13,0mm	03
TCN 614	T.F.R. 40,00mm, CHAV. 5/16", C/AP. LAT., C/ INT., F. TRV. 13,0mm	03
TCN 615	T.F.R. 35,00mm, CHAV. 5/16", C/AP. LAT., C/ INT., F. TRV. 13,0mm	03
TCN 616	T.F.R. 52,00mm, F. TRV. 10,0mm	07
TCN 617	T. 6 ESTRIAS 1.3/4", C/ AP. LAT., C/ INT., F. TRV. 13,0mm	05
TCN 618	T. 6 ESTRIAS 1.3/4", C/ AP. LAT., C/ INT., F. TRV. 16,0mm	05
TCN 619	T.F.R. 40,00mm, CHAV. 1/2", C/ AP. LAT., C/ INT., F. TRV. 13,0mm	03
TCN 620	T.F.R. 40,00mm, CHAV. 3/8", C/ AP. LAT., C/ INT., F. TRV. 13,0mm	03
TCN 622	T.F.R. 41,50mm	09
TCN 624	T.F.R. 48,00mm	09
TCN 625	T.F.R. 32,00mm, CHAV. 5/16", C/ AP. LAT., C/ INT., F. TRV. 13,0mm	03
TCN 629	T.F.R. 35,00mm, F. TRV. 13,0mm	07
TCN 632	T.F.R. 45,00mm, CHAV. 12,0mm, C/ AP. LAT., C/ INT., F. TRV. 13,0mm	03
TCN 637	T.F.R. 50,00mm, CHAV. 3/8"	08
TCN 638	T.F. SEXTAVADO 31,75mm, C/ AP. LAT., C/ INT., F. TRV. 13,0mm	10
TCN 639	T.F. SEXTAVADO 31,75mm, C/ ENGATE RÁPIDO 14,0x9,0mm	11
TCN 642	T. 21 ESTRIAS, C/ AP. LAT., F. TRV. 13,0mm	12

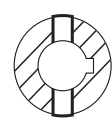
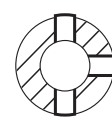
Figura 01



Figura 02



Figura 03

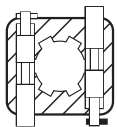

Figura 04

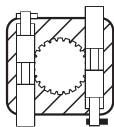

Figura 05

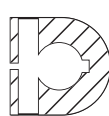

Figura 06

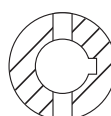

Figura 07

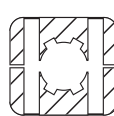

Figura 08

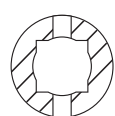

Figura 09

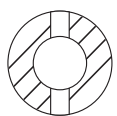

Figura 10

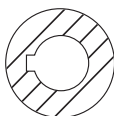

Figura 11

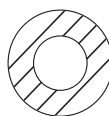

Figura 12



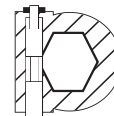
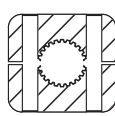

OVAL - SÉRIE 1000

CÓDIGO	DESCRIÇÃO	FIGURA
TWN 10	T.E.R. 6 ESTRIAS 1.3/8", F. 14,0mm	01
TWN 10E	T.E.R. 21 ESTRIAS, F. 14,0mm	02
TWN 11	T.F. OVAL 40,10mm	03
TWN 12	T.F. OVAL 48,00mm	03
TWN 13	T.F.R. 30,00mm, F. TRV. 10,0mm	04
TWN 14	T.F.R. 30,00mm, CHAV. 5/16", C/ AP. LAT., S/ INT., F. 13,0mm	05
TWN 15	T.F.R. 35,00mm, CHAV. 5/16", C/ AP. LAT., C/ INT., F. 13,0mm	06
TWN 18	T. FLANGE 125,00mm, C/ 4 F. 14,0mm, DIST. CENTRO 97,4mm	10
TWN 19	T.F.R. 30,00mm, CHAV. 5/16", F. TRV. 10,0mm	07
TWN 102	T.F.R. 35,00mm, CHAV. 10,0mm, C/ AP. LAT., S/ INT., F. 13,0mm	05
TWN 103	T.F.R. 19,05mm, CHAV. 1/4", F. TRV. 3/8", C/ ROSCA	09
TWN 104	T.F.R. 30,00mm, CHAV. 3/8", F. C/ ROSCA 3/8" A 180° DA CHAV.	08
TWN 106	T.F.R. 30,00mm, CHAV. 5/16", F. TRV. 3/8", C/ ROSCA	09
TWN 108	T.F.R. 30,00mm, CHAV. 3/8", F. TRV. 10,0mm	07
TWN 109	T.F.R. 30,00mm, CHAV. 5/16", C/ AP. LAT., C/ INT., F. 13,0mm	06
TWN 110	T.F.R. 35,00mm, CHAV. 3/8", F. TRV. 10,0mm	07
TWN 113	T.F.R. 29,20mm, CHAV. 10,0mm, C/ AP. LAT., S/ INT., F. 13,0mm	05
TWN 115	T.F.R. 30,00mm, CHAV. 5/16", C/ AP. LAT., C/ INT., F. 13,0mm, C/ RAIOS DE INT. 20,5mm	06
TWN 117	T. FLANGE 125,00mm, PIL. 61,4mm, C/ 4 F. 13,0mm, DIST. CENTRO 100,0mm	10
TWN 120	T. FLANGE 115,00mm, PIL. 9,4mm, C/ 4 F. 10,5mm, DIST. CENTRO 61,0x73,0mm	10
TWN 121	T.F.R. 25,40mm, CHAV. 1/4", F. C/ ROSCA 3/8" A 180° DA CHAV.	08
TWN 128	T. FLANGE 125,00mm, ESPESSURA 11,0mm, S/ FURAÇÃO E S/ PILOTO (LISO)	10
TWN 131	T. FLANGE 100,00mm, C/ 4 F. 9,0mm E 4 F. 12,0mm	10
TWN 133	T.F.R. 30,00mm, CHAV. 3/8", C/ AP. LAT., S/ INT., F. 13,0mm	05
TWN 135	T.F.Q. 22,50mm, F. TRV. 10,0mm	11
TWN 136	T.F.R. 25,50mm, F. TRV. 10,0mm	04
TWN 138	T.F.R. 35,00mm, CHAV. 3/8", F. TRV. C/ ROSCA 3/8"	09
TWN 139	TERMINAL GIRO LIVRE - CONJUNTO	12
TWN 141	T.F.R. 35,00mm, CHAV. 3/8", C/ AP. LAT., C/ INT., F. 13,0mm	06
TWN 148	T.F.R. 35,00mm, CHAV. 10,0mm, C/ AP. LAT., C/ INT., F. 13,0mm	06
TWN 149	T. FLANGE 120,00mm, PIL. 71,4mm, C/ 4 F. 14,0mm, DIST. CENTRO 97,4mm	10
TWN 151	T.F.R. 25,40mm, CHAV. 1/4", F. TRV. C/ ROSCA 3/8"	09
TWN 153	T.F.R. 22,20mm, CHAV. 1/4", F. TRV. 8,0mm	07
TWN 156	T.F.R. 20,70mm, CHAV. 1/4", F. TRV. C/ ROSCA 3/8"	09
TWN 162	T. FLANGE 125,00mm, C/ 4 F. 14,0mm, DIST. CENTRO 100,0mm	10
TWN 185	T. FLANGE 97,70mm, PIL. 60,2x1,5mm, C/ 4 F. 10,5mm, DIST. CENTRO 79,5mm (VOLVO)	10

Figura 01



Figura 02



Figura 03



Figura 04

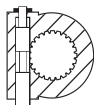

Figura 05

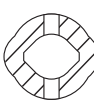

Figura 06

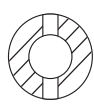

Figura 07

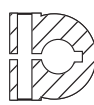

Figura 08

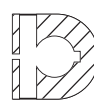

Figura 09

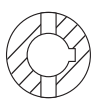

Figura 10



Figura 11

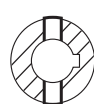

Figura 12

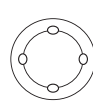

OVAL - SÉRIE 2000

CÓDIGO	DESCRIÇÃO	FIGURA
TWN 20	T.E.R. 6 ESTRIAS 1.3/8", F. 14,0mm	01
TWN 20E	T.E.R. 21 ESTRIAS, F. 14,0mm	02
TWN 21	T.F. OVAL 57,50mm	03
TWN 22	T.F. OVAL 49,00mm	03
TWN 23	T.F.R. 35,00mm, CHAV. 3/8", F. TRV. 12,0mm	07
TWN 23E	T.F.R. 35,00mm	08
TWN 24	T.F.R. 30,00mm, CHAV. 3/8", F. TRV. 10,0mm	07
TWN 25	T.F.R. 35,00mm, CHAV. 3/8", C/ AP. LAT., C/ INT., F. 13,0mm	06
TWN 26	T. FLANGE 125,00mm, C/ 4 F. 14,0mm, DIST. CENTRO 97,4mm	11
TWN 32	T.F.R. 35,00mm, CHAV. 10mm, C/ AP. LAT., S/ INT., F. 13,0mm	05
TWN 33	T. 6 ESTRIAS 1.3/8", C/ AP. LAT., C/ INT., F. 13,0mm	09
TWN 38	T.F.R. 38,00mm, CHAV. 3/8", F. C/ ROSCA 3/8" A 180° DA CHAV.	10
TWN 39	T.F.R. 35,00mm, CHAV. 3/8", F. TRV. 10,0mm	07
TWN 43	T.F.R. 30,00mm, CHAV. 3/8", F. TRV. 12,0mm	07
TWN 47	T.F.R. 31,50mm, CHAV. 1/4", F. C/ ROSCA 3/8" A 180° DA CHAV.	10
TWN 49	T.F.R. 30,00mm, CHAV. 5/16", C/ AP. LAT., S/ INT., F. 13,0mm	05
TWN 201	T.F.R. 35,00mm, F. TRV. 13,0mm	04
TWN 202	T.F.R. 30,00mm, F. TRV. 10,0mm	04
TWN 203	T.F.R. 35,00mm, CHAV. 5/16", C/ AP. LAT., S/ INT., F. 13,0mm	05
TWN 219	T.F.R. 35,00mm, F. TRV. 10,0mm	04
TWN 220	T.F.R. 35,00mm, F. TRV. 12,0mm	04
TWN 221	T.F.R. 35,00mm, CHAV. 10mm, C/ AP. LAT., C/ INT., F. 13,0mm	06
TWN 229	T. FLANGE 120,00mm, C/ 4 F. 13,0mm, DIST. CENTRO 100,0mm	11
TWN 230	T. FLANGE 125,00mm, C/ 4 F. 14,0mm, DIST. CENTRO 100,0mm	11
TWN 238	TERMINAL GIRO LIVRE - CONJUNTO	12

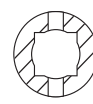
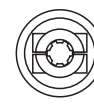
Figura 01



Figura 02



Figura 03

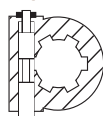

Figura 04

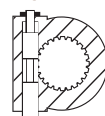

Figura 05

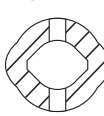

Figura 06

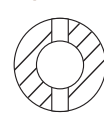

Figura 07



Figura 08



Figura 09

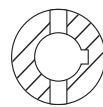

Figura 10

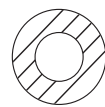

Figura 11



Figura 12



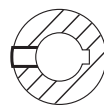

OVAL - SÉRIE 2500

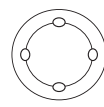
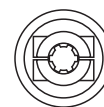
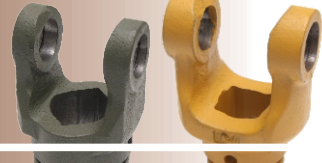
CÓDIGO	DESCRIÇÃO	FIGURA
TWN 420	T.E.R. 6 ESTRIAS 1.3/8", F. 14,0mm	01
TWN 420E	T.E.R. 21 ESTRIAS, F. 14,0mm	02
TWN 421	T.F. OVAL 57,50mm	03
TWN 422	T.F. OVAL 49,00mm	03
TWN 403	T.F. SEXTAVADO 28,65mm, C/ AP. LAT., C/ INT., F. TRV. 13,0mm	07
TWN 404	T.F.R. 35,00mm, CHAV. 3/8", F. TRV. 12,0mm, F. C/ ROSCA 1/2" A 180° DA CHAV.	09
TWN 406	T.F.R. 30,00mm, CHAV. 5/16", C/ AP. LAT., C/ INT., F. 13,0mm	04
TWN 423	T.F.R. 35,00mm, CHAV. 3/8", F. TRV. 12,0mm	05
TWN 424	T.F.R. 30,00mm, CHAV. 3/8", F. TRV. 10,0mm	05
TWN 425	T.F.R. 35,00mm, CHAV. 3/8", C/ AP. LAT., C/ INT., F. 13,0mm	04
TWN 433	T. 6 ESTRIAS 1.3/8", C/ AP. LAT., C/ INT., F. 13,0mm	06
TWN 447	T.F. SEXTAVADO 31,75mm, C/ ENGATE RÁPIDO	08
TWN 448	T.F. SEXTAVADO 31,75mm, C/ AP. LAT., C/ INT., F. 13,0mm	07
TWN 450	T.F.R. 35,00mm, CHAV. 3/8", F. TRV. 12,0mm	05
TWN 459	T.F. SEXTAVADO 28,60mm, C/ ENGATE RÁPIDO	08

Figura 01



Figura 02



Figura 03

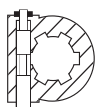

Figura 04

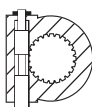

Figura 05

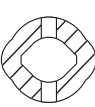

Figura 06



Figura 07

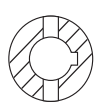

Figura 08



Figura 09



TRIANGULAR - SÉRIE 1000

CÓDIGO	DESCRIÇÃO	FIGURA
TIN 11	T.F. TRIANGULAR 29,00mm, F. TRV. 10,0mm	01
TIN 12	T.F. TRIANGULAR 36,00mm, F. TRV. 10,0mm	01

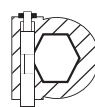
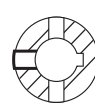
TRIANGULAR - SÉRIE 2500

CÓDIGO	DESCRIÇÃO	FIGURA
TIN 251	T.F. TRIANGULAR 52,50mm, F. TRV. 10,0mm	01
TIN 252	T.F. TRIANGULAR 45,30mm, F. TRV. 10,0mm	01

TRIANGULAR - SÉRIE 5000

CÓDIGO	DESCRIÇÃO	FIGURA
TIN 51	T.F. TRIANGULAR 52,50mm, F. TRV. 10,0mm	01
TIN 52	T.F. TRIANGULAR 45,30mm, F. TRV. 10,0mm	01

Obs.: Séries com medidas de rolamento (cruzetas) compatíveis com séries de perfil quadrado.

Figura 01

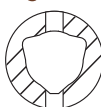

TRIANGULAR EXPORTAÇÃO - SÉRIE 1002

CÓDIGO	DESCRIÇÃO	FIGURA
TIN 2001	T.E.R. 6 ESTRIAS 1.3/8", F. 14,0mm	01
TIN 2002	T.E.R. 21 ESTRIAS, F. 14,0mm	02
TIN 2007	T. 6 ESTRIAS 1.3/8", C/ AP. LAT., C/ INT., F. TRV. 13,0mm	06
TIN 2009	T. 6 ESTRIAS 1.3/8", F. TRV. 8,0mm	12
TIN 2011	T. 21 ESTRIAS, C/ AP. LAT., C/ INT., F. TRV. 13,0mm	13
TIN 2018	T.F. TRIANGULAR 29,30mm, F. TRV. 10,0mm	03
TIN 2019	T.F. TRIANGULAR 36,30mm, F. TRV. 10,0mm	03
TIN 2050	T.F.Q. 22,20mm, F. TRV. 8,0mm	14
TIN 2086	T.F.R. 25,40mm, CHAV. 1/4", F. C/ ROSCA 3/8" A 180° DA CHAV.	15
TIN 2087	T.F.R. 25,40mm, CHAV. 1/4", F. TRV. C/ ROSCA 3/8"	09
TIN 2097	T.F.R. 30,00mm, F. TRV. 10,0mm	16
TIN 2107	T.F.R. 30,00mm, CHAV. 5/16", C/ AP. LAT., S/ INT., F. 13,0mm	17
TIN 2116	T.F.R. 31,75mm, CHAV. 5/16", F. TRV. C/ ROSCA 3/8"	09
TIN 2128	T.F.R. 35,00mm, CHAV. 3/8", F. TRV. C/ ROSCA 3/8"	09
TIN 2133	T.F.R. 35,00mm, CHAV. 5/16", C/ AP. LAT., C/ INT., F. TRV. 13,0mm	04
TIN 2143	TERMINAL GIRO LIVRE - CONJUNTO	10
TIN 2165	T.F.R. 30,00mm, CHAV. 8,0mm, F. TRV. C/ ROSCA M10	09
TIN 2166	T.F.R. 19,05mm, CHAV. 3/16", F. TRV. C/ ROSCA M10	09
TIN 2174	T. 21 ESTRIAS, F. TRV. 8,0mm	11
TIN 2176	T.F.R. 19,05mm, F. TRV. C/ ROSCA 3/8"	08
TIN 2177	T.F.R. 25,40mm, F. TRV. 3/8"	16
TIN 2178	T.F.R. 31,75mm, F. TRV. 3/8"	16
TIN 2188	T.F.R. 30,00mm, CHAV. 8,0mm, C/ AP. LAT., S/ INT., F. TRV. 13,0mm	17
TIN 2189	T.F.R. 19,05mm, CHAV. 3/16", F. TRV. 13,0mm	05
TIN 2190	T.F.R. 25,40mm, CHAV. 1/4", F. TRV. 13,0mm	05
TIN 2192	T.F.R. 31,75mm, CHAV. 5/16", F. TRV. 13,0mm	05
TIN 2203	TERMINAL GIRO LIVRE, 21 ESTRIAS - CONJUNTO	10
TIN 2218	T.F.R. 25,00mm, CHAV. 8,0mm, F. TRV. C/ ROSCA M10	09
TIN 2231	T.F.R. 30,00mm, CHAV. 3/8", C/ AP. LAT., C/ INT., F. TRV. 13,0mm	04
TIN 2309	T.F. SEXTAVADO 28,57mm, C/ AP. LAT., C/ INT., F. 13,0mm	07

Figura 01



Figura 02



Figura 03

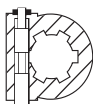

Figura 04

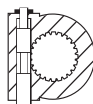

Figura 05

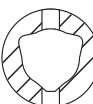

Figura 06

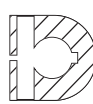

Figura 07

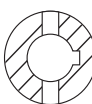

Figura 08



Figura 09

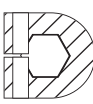

Figura 10

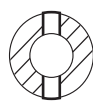

Figura 11

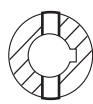

Figura 12



Figura 13

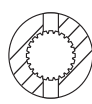

Figura 14

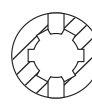

Figura 15

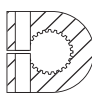

Figura 16

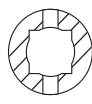

Figura 17



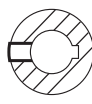

TRIANGULAR EXPORTAÇÃO - SÉRIE 2004

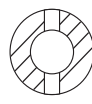
CÓDIGO	DESCRIÇÃO	FIGURA
TIN 4001	T.E.R. 6 ESTRIAS 1.3/8", F. 14,0mm	01
TIN 4002	T.E.R. 21 ESTRIAS, F. 14,0mm	02
TIN 4005	T.F.R. 35,00mm, F. TRV. 1/2"	16
TIN 4009	T. 6 ESTRIAS 1.3/8", F. TRV. 8,0mm	12
TIN 4011	T. 6 ESTRIAS 1.3/8", C/ AP. LAT., C/ INT., F. TRV. 13,0mm	06
TIN 4018	T.F. TRIANGULAR 36,40mm, F. TRV. 10,0mm	03
TIN 4019	T.F. TRIANGULAR 43,60mm, F. TRV. 10,0mm	03
TIN 4066	T.F.R. 20,70mm, CHAV. 1/4", F. TRV. C/ ROSCA 3/8"	09
TIN 4069	T.F.R. 35,00mm, CHAV. 3/8", C/ AP. LAT., C/ INT., F. TRV. 13,0mm	04
TIN 4087	T.F.R. 25,40mm, CHAV. 1/4", F. TRV. C/ ROSCA 3/8"	09
TIN 4090	T.F.R. 25,40mm, CHAV. 1/4", F. C/ ROSCA 3/8" A 180° DA CHAV.	15
TIN 4097	T.F.R. 35,00mm, F. TRV. 10,0mm	16
TIN 4107	T.F.R. 30,00mm, CHAV. 5/16", C/ AP. LAT., S/ INT., F. TRV. 13,0mm	14
TIN 4115	T.F.R. 30,00mm, CHAV. 5/16", F. TRV. 10,0mm	05
TIN 4116	T.F.R. 31,75mm, CHAV. 5/16", F. TRV. C/ ROSCA 3/8"	09
TIN 4121	T.F.R. 35,00mm, F. TRV. 13,0mm	16
TIN 4122	T.F.R. 35,00mm, CHAV. 10,0mm, C/ AP. LAT., S/ INT., F. TRV. 13,0mm	14
TIN 4125	T.F.R. 35,00mm, CHAV. 10,0mm, C/ AP. LAT., C/ INT., F. TRV. 13,0mm	04
TIN 4133	T.F.R. 35,00mm, CHAV. 5/16", C/ AP. LAT., C/ INT., F. TRV. 13,0mm	04
TIN 4161	T.F.R. 30,00mm, CHAV. 10,0mm, F. TRV. 5,0mm	05
TIN 4165	T.F.R. 30,00mm, CHAV. 8,0mm, F. TRV. C/ ROSCA M10	09
TIN 4168	T.F.R. 35,00mm, CHAV. 10mm, F. TRV. C/ ROSCA M12	09
TIN 4170	T.F.R. 35,00mm, CHAV. 5/16", F. TRV. C/ ROSCA 3/8"	09
TIN 4174	T. 21 ESTRIAS, F. TRV. 8,0mm	11
TIN 4178	T.F.R. 31,75mm, F. TRV. 3/8"	16
TIN 4179	T.F.R. 35,00mm, F. TRV. 3/8"	16
TIN 4188	T.F.R. 30,00mm, CHAV. 8,0mm, C/ AP. LAT., S/ INT., F. TRV. 13,0mm	14
TIN 4192	T.F.R. 31,75mm, CHAV. 5/16", F. TRV. 13,0mm	05
TIN 4210	T.F.R. 35,00mm, F. C/ ROSCA M12	08
TIN 4222	T.F.R. 32,00mm, CHAV. 8,0mm, F. C/ ROSCA M10 A 90° DA CHAV. E NÃO PASSANTE	17
TIN 4229	T.F. SEXTAVADO 28,57mm, C/ AP. LAT., C/ INT., F. 13,0mm	07
TIN 4235	T.F. SEXTAVADO 31,75mm, C/ ENGATE RÁPIDO	10
TIN 4307	T.F. SEXTAVADO 31,75mm, C/ AP. LAT., S/ INT., F. 13,0mm	13
TIN 4309	T.F. SEXTAVADO 28,57mm, C/ AP. LAT., C/ INT., F. 13,0mm	07
TIN 4310	T.F. SEXTAVADO 31,75mm, C/ AP. LAT., C/ INT., F. 13,0mm	07
TIN 4316	T.F. SEXTAVADO 28,75mm, C/ ENGATE RÁPIDO	10
TIN 4320	T.F.R. 30,00mm, CHAV. 8,0mm, C/ AP. LAT., C/ INT., F. TRV. 13,0mm	04

Figura 01



Figura 02



Figura 03

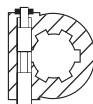

Figura 04

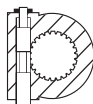

Figura 05

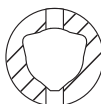

Figura 06

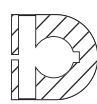

Figura 07

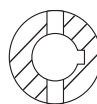

Figura 08



Figura 09

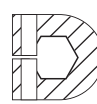

Figura 10

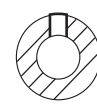

Figura 11

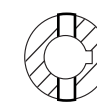

Figura 12

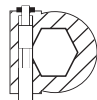

Figura 13

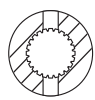

Figura 14

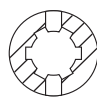

Figura 15

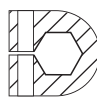

Figura 16



Figura 17

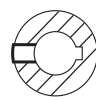
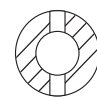